

PROJECT TITLE PROPOSED P. FIVE STORIED HOUSING BLDG BLDG IN A RESIDENTIAL COMPLEX AT PATHARGHATA GRAM PANCHAYET SAMITY	OWNER(S) :- (Demarcated in the Site Plan as Part B) 1. SRI NARENDRA CHANDRA GARG S/O SRI YOGRAJ GARG 2. SRI NIRMAL GARG S/O SRI YOGRAJ GARG	LAND SCHEDULE :- PLOT NO : 95, 96, 97 (OLD), 323, 324, 325 (NEW) KHATAN NO : 774 (OLD), 60, 73, 165, 166; 227 (NEW) MOUZA : BANIAKHARI	JL NO : 55 PS : MATIGARA PARGANA : PATHARGHATA DIST : DARJEELING	LOCATION OF SITE :- MATIGARA, KHAPRAIL ROAD UNDER PATHARGHATA GRAM PANCHAYAT SAMITY
--	---	--	---	--

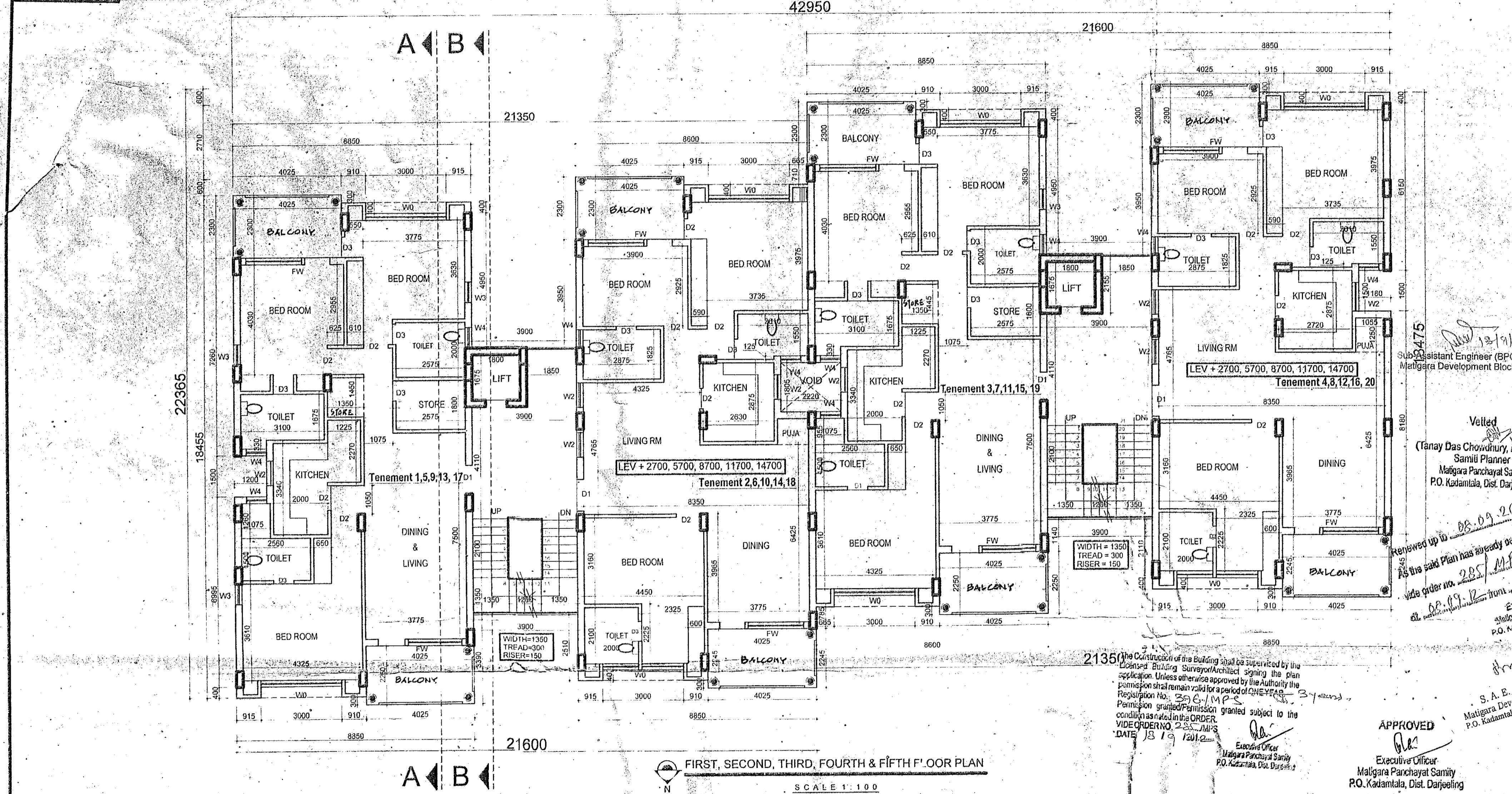

FIRST, SECOND, THIRD, FOURTH & FIFTH FLOOR PLAN
 SCALE 1:100

Sub Assistant Engineer (BPC)
 Matigara Development Block
 08.09.2019
 Renewed up to 08.09.2019
 As this said Plan has already been approved
 vide order no. 285/MPS
 08.09.2019
 S.A.E. (NRDD)
 Matigara Development Block
 P.O. Kadamtala, Dist. Darjeeling

APPROVED
 Executive Officer
 Matigara Panchayat Samity
 P.O. Kadamtala, Dist. Darjeeling

I do hereby confirm and certify with full responsibility that the building plan has been drawn as per provisions of T & CP Act 1979 and ODP of Siliguri Jalpaiguri Development Authority as amended from time to time and that the site conditions including the width of the abutting common passage or SMC / Anchal Road conform with the plan and it is a buildable site and not a tank or filled up tank. It is an absolute vacant and solid land.

Aniruddha Sanyal
 ANIRUDDHA SANYAL M. Arch (JU)
 Architect & Urban Designer
 CGA Regd. No. 07/2022955

SIGNATURE OF ARCHITECT

The structural design and drawings of both foundation and super structure of the building has been made by me considering all possible load including the seismic load as per the national building code of India and certified that it is safe and stable in all respects.

Vinay Kumar
 Licensed Building Surveyor
 SIDA Regd. No. - LBS/AN/11

SIGNATURE OF STRUCTURAL ENGINEER

I do hereby declare that the building proposed for construction shall be supervised by the BA / LBA signing the Building Plan application or in his absence by any other BA / LBS of the appropriate category and as approved by the authority.

Narendra C Garg & Nirmal Garg
 Narendra C Garg
 &
 Nirmal Garg

SIGNATURE OF OWNER (S)

NOTES :-

- # All dimensions in millimetre.
- # All External & Internal walls 125 Th. unless otherwise stated.
- # Only written dimensions to be followed.
- # General specifications for materials & workmanship as per NBC 1984.
- # First class Brick work in 4:1:6:1 sand cement mortar.
- # Grade of concrete M20 & that of steel Fe415.

DOORS & WINDOWS :-		REMARKS	
TYPE	DIMENSION	SECTION	REMARKS
DW	3000 x 2100	150 x 65	FRENCH WINDOW
D1	1950 x 2100	150 x 65	FRENCH WINDOW
D2	1000 x 2100	- do -	FRENCH WINDOW
D3	750 x 2100	- do -	FRENCH WINDOW
W0	3000 x 1200	125 x 85	FRENCH WINDOW
W1	2000 x 1200	- do -	FRENCH WINDOW
W2	900 x 1000	- do -	FRENCH WINDOW
W3	750 x 1200	- do -	FRENCH WINDOW
W4	900 x 450	- do -	FRENCH WINDOW
FW	3000 x 2100	- do -	FRENCH WINDOW
CG			ROLLING SHUTTER
RS			GLAZING WINDOW
GW			GLAZING WINDOW

DRAWING TITLE :-
 FIRST, SECOND, THIRD, 4TH & 5TH FLR PLAN

SCALE 1:100
 DATE 24-02-2009

DEALT
 MANIK GHOSH

JOB NO
 0707-A-SJDA

SHEET NO
 0707-A-3/11

CHECKED
 ANIRUDDHA SANYAL

